

PARTS BULLETIN

URGENT: Please distribute copies for the following people within your organization:

☒ Owner ☒ Sales ☒ Customer Service ☒ Service Techs

Subject: Shim Kit for DS35, DS35EX and RLP77

Dear valued distributor,

Please be noted that a new shim kit with part number DS35-SHK has been developed for Rotary DS35,DS35EX and RLP77.

When your technicians install the Rotary DS35,DS35EX and RLP77 double scissor lift, we suggest they should also install the shim kit if the ground is uneven.

The shim kit DS35-SHK includes 4 pcs of XX120002-1 and 4 pcs of XX120002-2 shim plates.

Please see details as below.

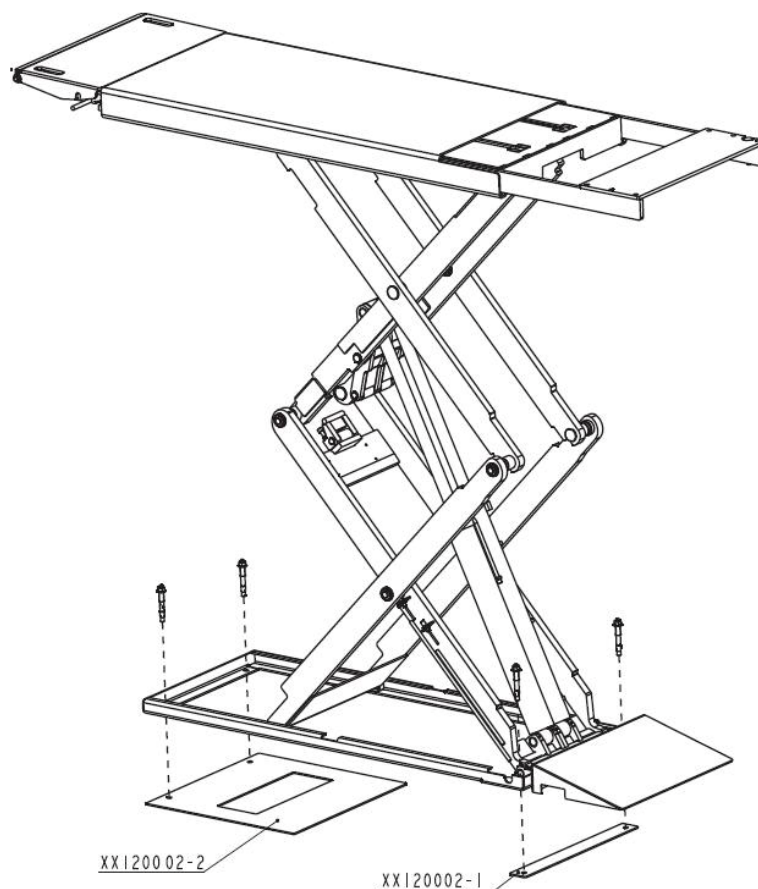

For any questions concerning this announcement, please direct to our customer support at huihua.lu@rotaryliftdasia.com.

Regards,

VSGA Customer Service

2018/12/17